

WF2504 Series

2.50mm pitch/Wire-to-board Connector

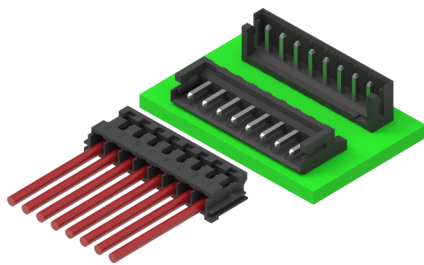

WF2504 系列

2.50mm间距/线到板连接器

Overview

WF2504 is a 2.50mm pitch wire-to-board connector that combines high density, high performance, and high integration. It effectively ensures stable and complete signal transmission. The board side offers both horizontal and vertical mounting options to accommodate different mating angles.

概述

WF2504是一款2.50mm间距线到板连接器，产品兼具高密度、高性能、高集成等优点，能有效确保信号传输的稳定性以及完整性，板端提供水平及垂直方向贴板安装，满足客户不同角度对插适配。

Features and Benefits

- Anti-misplug structure
- Compact size with high integration
- Offers straight and angled pins for selection

产品特点

- 防误插结构
- 产品体积小，集成度高
- 提供直针、弯针供选择

Product Applications

- Industrial Equipment: Automation equipment, sensors, control units
- Computers: Motherboards, fans, hard drives
- Lighting Equipment: LED fixtures, lighting systems

应用领域

- 工业设备：自动化设备、传感器、控制单元
- 计算机：主板、风扇、硬盘
- 照明设备：LED灯具、照明系统

Standard 标准

- EIA-364

UL certification UL认证

- E248993

Material 材料

Part/零件	Material/材料	Finish/电镀	UL Flame retardant/阻燃等级
Housing/主体	PA66	White/白色 Black/黑色	UL94V-0
Header/板端	PA66/PA46	White/白色 Black/黑色	UL94V-0
Terminal/端子	Copper alloy 铜合金	Gold-plated/镀金 Tin-plated/镀锡	/

Production Specifications 产品规格

Current rating 额定电流	3.0A	Operating Temperature Range:-40°C~+105°C (including temperature rise) Operating Humidity Range:20-80% 工作温度范围: -40°C~+105°C(含温升) 工作湿度范围: ≤80%	Storage temperature: Humidity: 储存温度: 25±5°C 储存湿度: ≤60%
Voltage rating 额定电压	250V		

Item 项目	Condition 条件	Specification 规格
Insulation Resistance 绝缘电阻	Measured at 800V DC for 1 minute 测试电压: 800V DC/1分钟	No less than 1000MΩ 不少于1000MΩ
Withstanding voltage 耐电压	Measured at 800V AC for 1 minute 测试电压: 800V AC/1分钟	No breakdown, no discharge, leakage current <0.5 mA 无击穿、无放电、漏电流<0.5 mA
Contact Resistance 接触电阻	Measured at 100mA and no higher than 20mV 用20 mV DC进行测量	Contact resistance: Initial value/ 20 mΩ max After environmental tests/ 30 mΩ max. 接触电阻: 初始值 20 mΩ 以下 测试后 30 mΩ 以下
Vibration Resistance 抗振动	Frequency : 50 ~ 2000 Hz PSD value : 5.35 Gms minimum Duration : 15 minutes/axis Times : Each of three mutually perpendicular planes. 频率: 50 ~ 2000 Hz PSD值: 5.35 Gms 时长: 15分钟/轴 次数: 3次	No electrical discontinuity of 1μsorgreater 试验过程中未发生1μs瞬断现象, 且外观无损伤, 电气性能正常
Humidity (Steady state) 湿度	Temperature : 25~65°C Humidity: 90 ~95% (R.H) Duration : 96 hours 温度: 25~65° C 湿度: 90 ~95% (R.H) 时间: 96小时	Contact resistance: Initial value/ 20 mΩ max After environmental tests/ 30 mΩ max. 接触电阻: 初始值 20 mΩ 以下 测试后 30 mΩ 以下
Salt Spray 盐雾	Temperature:35±2°C Humidity:95~98%(R.H) PHValue : 6.5 ~ 7.2 Duration : 48hours (Gold Area) 温度: 35±2° C 湿度: 95~98%(R.H) PH值: 6.5~7.2 时间: 48小时(镀金区)	Contact resistance: Initial value/ 20 mΩ max After environmental tests/ 30 mΩ max. 接触电阻: 初始值 20 mΩ 以下 测试后 30 mΩ 以下
Durability(Mating/un-mating) 插拔寿命	30 cycles 循环30次	Contact resistance: Initial value/ 20 mΩ max After environmental tests/ 30 mΩ max. 接触电阻: 初始值 20 mΩ 以下 测试后 30 mΩ 以下

WF2504 Series

Order Information 订购信息

Circuit 芯数	Part number 型号		Plating 电镀	Dimensions 尺寸 (mm)		Package 包装 Qty/Bag 只/袋装	Remake 可量产状态
	TYPE-1	TYPE-2		A	B		
2	WF2504-WR(H)02W01	WF2504-WR(H)02W02	XX: S0=1U"Gold/Tin S3=10U"Gold/Tin G0=Gold Flash G3=10u" Gold Blank=Tin	2.50	7.50	1000	*
3	WF2504-WR(H)03W01	WF2504-WR(H)03W02		5.00	10.00	1000	*
4	WF2504-WR(H)04W01	WF2504-WR(H)04W02		7.50	12.50	1000	*
5	WF2504-WR(H)05W01	WF2504-WR(H)05W02		10.00	15.00	1000	*
6	WF2504-WR(H)06W01	WF2504-WR(H)06W02		12.50	17.50	1000	*
7	WF2504-WR(H)07W01	WF2504-WR(H)07W02		15.00	20.00	1000	*
8	WF2504-WR(H)08W01	WF2504-WR(H)08W02		17.50	22.50	1000	*
9	WF2504-WR(H)09W01	WF2504-WR(H)09W02		20.00	25.00	1000	*
10	WF2504-WR(H)10W01	WF2504-WR(H)10W02		22.50	27.50	1000	*
11	WF2504-WR(H)11W01	WF2504-WR(H)11W02		25.00	30.00	1000	*
12	WF2504-WR(H)12W01	WF2504-WR(H)12W02		27.50	32.50	1000	*
13	WF2504-WR(H)13W01	WF2504-WR(H)13W02		30.00	35.00	1000	*
14	WF2504-WR(H)14W01	WF2504-WR(H)14W02		32.50	37.50	1000	*
15	WF2504-WR(H)15W01	WF2504-WR(H)15W02		35.00	40.00	1000	*
16	WF2504-WR(H)16W01	WF2504-WR(H)16W02		37.50	42.50	1000	*
20	WF2504-WR(H)20W01	WF2504-WR(H)20W02		47.50	52.50	1000	*

Note: * stands for mass production . 注: *代表可量产

Dimensions 尺寸 (R/A)

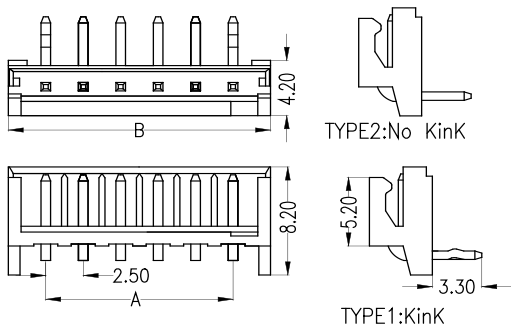

Assembly Schematic 装配示意

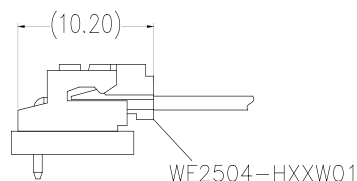

PCB Layout 印刷电路板布局

Through-hole type 通孔型

R/A DIP

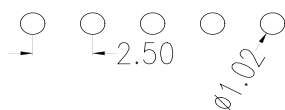

Order Information 订购信息

Circuit 芯数	Part number 型号		Plating 电镀	Dimensions 尺寸 (mm)		Package 包装 Qty/Bag 只/袋装	Remake 可量产状态
	TYPE-1	TYPE-2		A	B		
2	WF2504-WS(H)02W01	WF2504-WS(H)02W02	XX: S0=10u"Gold/Tin S3=10u"Gold/Tin G0=Gold Flash G3=10u" Gold Blank=Tin	2.50	7.50	1000	*
3	WF2504-WS(H)03W01	WF2504-WS(H)03W02		5.00	10.00	1000	*
4	WF2504-WS(H)04W01	WF2504-WS(H)04W02		7.50	12.50	1000	*
5	WF2504-WS(H)05W01	WF2504-WS(H)05W02		10.00	15.00	1000	*
6	WF2504-WS(H)06W01	WF2504-WS(H)06W02		12.50	17.50	1000	*
7	WF2504-WS(H)07W01	WF2504-WS(H)07W02		15.00	20.00	1000	*
8	WF2504-WS(H)08W01	WF2504-WS(H)08W02		17.50	22.50	1000	*
9	WF2504-WS(H)09W01	WF2504-WS(H)09W02		20.00	25.00	1000	*
10	WF2504-WS(H)10W01	WF2504-WS(H)10W02		22.50	27.50	1000	*
11	WF2504-WS(H)11W01	WF2504-WS(H)11W02		25.00	30.00	1000	*
12	WF2504-WS(H)12W01	WF2504-WS(H)12W02		27.50	32.50	1000	*
13	WF2504-WS(H)13W01	WF2504-WS(H)13W02		30.00	35.00	1000	*
14	WF2504-WS(H)14W01	WF2504-WS(H)14W02		32.50	37.50	1000	*
15	WF2504-WS(H)15W01	WF2504-WS(H)15W02		35.00	40.00	1000	*

Note: * stands for mass production . 注: *代表可量产

Dimensions 尺寸 (S/T)

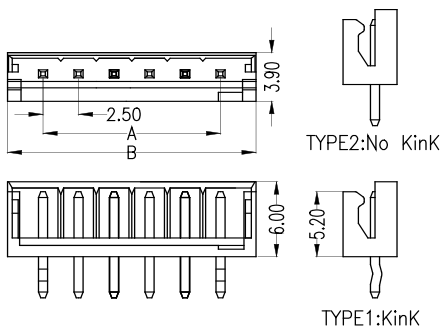

Assembly Schematic 装配示意

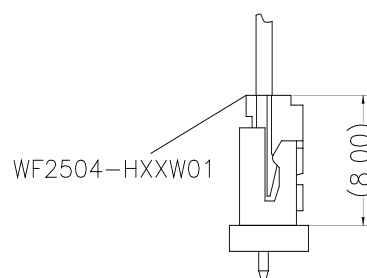

PCB Layout 印刷电路板布局

Through-hole type 通孔型
S/T DIP

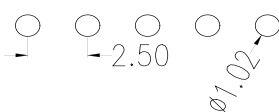

WF2504 Series

Dimensions 尺寸

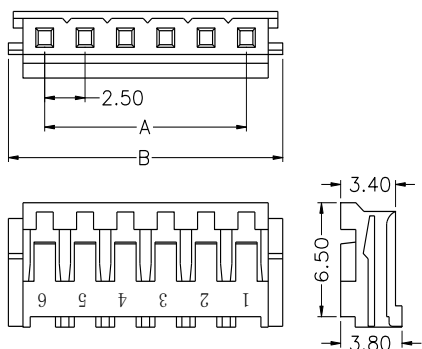

Adaptor Terminal 适配端子

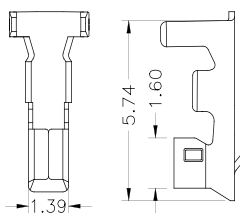

Part number 型号	Suitable wire diameter 适配线径
WF2504-TPXX01	22~28AWG

Order Information 订购信息

Circuit 芯数	Part number 型号	Dimensions 尺寸 (mm)		Package 包装 Q'ty/Bag 只/袋装	Remake 可量产状态
		A	B		
2	WF2504-H02W01	2.50	7.00	1000	*
3	WF2504-H03W01	5.00	9.50	1000	*
4	WF2504-H04W01	7.50	12.00	1000	*
5	WF2504-H05W01	10.00	14.50	1000	*
6	WF2504-H06W01	12.50	17.00	1000	*
7	WF2504-H07W01	15.00	19.50	1000	*
8	WF2504-H08W01	17.50	22.00	1000	*
9	WF2504-H09W01	20.00	24.50	1000	*
10	WF2504-H10W01	22.50	27.00	1000	*
11	WF2504-H11W01	25.00	29.50	1000	*
12	WF2504-H12W01	27.50	32.00	1000	*
13	WF2504-H13W01	30.00	34.50	1000	*
14	WF2504-H14W01	32.50	37.00	1000	*
15	WF2504-H15W01	35.00	39.50	1000	*
16	WF2504-H16W01	37.50	42.00	1000	*

Note: * stands for mass production . 注: *代表可量产

Model Numbering 型号命名

WF2504	-	XX	(H)	XX	XX	X	X	X
(1)	(2)	(3)	(4)	(5)	(6)	(7)	(8)	
(1) Series (系列): Wafer 2.50mm Series		(2) Terminal type (端子形态): WS=S/T DIP、WR=R/A DIP	(3) material (材质): H=High temperature material 高温料 Blank=Low temperature material 低温料	(4) Circuit (位数): 02=2P.....16=16P、20=20P	(5) Contact Plating (电镀): Blank=Tin、S2=5u" Gold /Tin、S3=10u" Gold /Tin、G2=5u" Gold、G3=10u" Gold	(6) Color (颜色): W=White、B=Black	(7) Packing (包装): 0=PE Bag、T=Tube	(8) Internal code (流水码): 1=Type 1、2=Type 2

WF2504	-	H	XX	W	0	1
(1)	(2)	(3)	(4)	(5)	(6)	
(1) Series (系列): Wafer 2.50mm Series		(2) Product type (产品类型): H=Crimp Type Housing		(4) Color (颜色): W=White、B=Black	(5) Packing (包装): 0=PE Bag	(6) Internal code (流水码)
(3) Circuit (位数): 02=2.....16=16P						

Contact Us 联系我们

维峰电子股份有限公司(总部)
 WCON ELECTRONICS CO.,LTD(HQ)
 地址:广东省东莞市虎门镇大宁文明路15号
 Add :No.15,Wenming Road,Danng Community, Humen Town,
 Dongguan, Guangdong,523930, China

昆山维康电子有限公司
 KUNSHAN WCON ELECTRONICIS CO.,LTD(East of China)
 地址:江苏昆山市千灯镇汶浦中路169号
 Add : No.169, WenPu Middle Road, QianDeng Town, Kunshan
 City, Jiangsu Province, China

合肥维峰电子有限公司
 HEFEI WCON ELECTRONICIS CO.,LTD
 地址:安徽合肥市高新技术开发区绿城科技园E栋2楼
 Add : 2F, Building E, Greentown Science Park,High-tech Develop-
 ment Zone, Hefei, Anhui,China

维康电子(泰国)有限公司
 WCON ELECTRONICS (Thailand) CO.,LTD
 地址:泰国巴真武里府西玛铺县华瓦区洛加纳工业园
 Add: VG3C+H57, Hua Wa, Si Maha Phot District, Prachin Buri
 25140, Thailand

销售联系方式 Sales Contacts

国际客户部 International Sales Department
 salesdg01@wcon.com
 salesdg05@wcon.com

大客户专线 Key Account Line
 华南: salesdg28@wcon.com
 华东: salesks@wcon.com

中小客户专线 Small and Medium-sized Account Line
 华南: salesdg10@wcon.com
 华东: salesks01@wcon.com

网络销售 Online sales
 salesdg26@wcon.com



Official Website



Product e-catalog



WeChat Public#



TikTok Public#