

0.80mm (0.032")pitch,SMT Board-to-Board Connector  
0.80毫米（0.032英寸）间距，表面贴装板对板连接器

### Overview

0.80mm pitch 3610 series product is a vertically mounted, dual-channel board-to-board connector. Its unique design ensures stable and reliable connections, meeting diverse requirements for use in confined spaces.

### 概述

0.80mm间距3610系列产品是一款垂直连接，双槽结构板对板连接器，独特的设计使连接更稳定可靠，满足多种狭小空间使用需求。

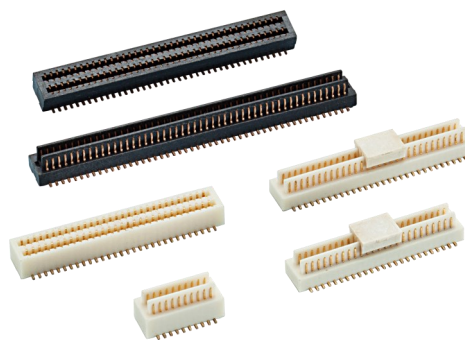

### Features and Benefits

- Compact size, high density
- Unique terminal design for stable and reliable contact
- Blind-fit pairing, straightforward installation
- Stacking height: 4–8 mm (selectable)

### 特点与优势

- 小体积，高密度
- 独特端子设计，接触稳定可靠
- 盲插对配，安装便捷
- 堆叠高度：4~8mm可选

### Product Applications

- Industrial Control and Automation, Instrumentation
- Communications and Networking, Data Centres
- Medical equipment

### 应用领域

- 工业控制与自动化、仪器仪表
- 通信与网络、数据中心
- 医疗设备

### Standard 标准

- EIA 364
- IEC 60512

### UL certification UL认证

- E248993

### Material 材料

Part/零件	Material/材料	Finish/电镀	UL Flame retardant/阻燃等级
Plug/插头	PA9T	Black/黑色 Beige/米黄色	UL94V-0
Socket/插座	PA9T	Black/黑色 Beige/米黄色	UL94V-0
Terminal/端子	Copper Alloy	Plated Au 镀金	-

Production Specifications 产品规格

Current rating 额定电流	0.5 A	Operating Temperature Range:-20° C~+105° (including temperature rise) Operating Humidity Range:20-80%	Storage Teroerature:25±5° C Humidity:≤60%
Voltage rating 额定电压	50V	工作温度范围: -20° C~+105° C(含温升) 工作湿度范围: 20-80%	储存温度: 25±5° C 储存湿度: ≤60%

Item 项目	Condition 条件	Specification 规格
Insulation Resistance 绝缘电阻	Measured at 500V DC for 1 minute 测试电压: 500V DC/1分钟	No less than 100M Ω 不少于100MΩ
Withstanding voltage 耐电压	Measured at 50V AC for 1 minute 测试电压: 50V AC/1分钟	No breakdown, no discharge, leakage current <0.5mA 无击穿、无放电、漏电流<0.5mA
Contact Resistance 接触电阻	Test Voltage 测试电压: 20mV Max Test current 测试电流: 100mA Max	Contact resistance: Initial value/ 50 mo max After environmental tests/ 70 mo max. 接触电阻: 初始值 50 mΩ 以下 测试后 70 mΩ 以下
Vibration Resistance 抗振动	Frequency: 50 ~ 2000 Hz PSD value: 5.35 G Duration: 15minutes/axis Vibration: X/Y/Z 频率: 20 ~ 2000 Hz PSD值: 5.35 G 时长: 15分钟/轴 方向: X/Y/Z	No electrical discontinuity of 1μsorgreater 试验过程中未发生1μs瞬断现象, 且外观无损伤, 电气性能正常
Humidity (Steady state) 湿度	Temperature: -25~+65° C Humidity: 90 ~95% (R.H) Duration: 96 hours 温度: -25~65° C 湿度: 90~95% (R.H) 时间: 96小时	Contact resistance: Initial value/ 50 mo max After environmental tests/ 70 mo max. 接触电阻: 初始值 50 mΩ 以下 测试后 70 mΩ 以下
Salt Spray 盐雾	Temperature 温度: 35±2°C Humidity 湿度: 95 ~ 98% (R.H) pH Value 酸碱值: 6.5~7.2 Duration 时间: 24H	Contact resistance: Initial value/ 50 mo max After environmental tests/ 70 mo max. 接触电阻: 初始值 50 mΩ 以下 测试后 70 mΩ 以下
Durability(Mating/un- mating) 插拔寿命	50 cycles 循环50次	Contact resistance: Initial value/ 50 mo max After environmental tests/ 70 mo max. 接触电阻: 初始值 50 mΩ 以下 测试后 70 mΩ 以下

Mating Height Chart 配合高度一览表

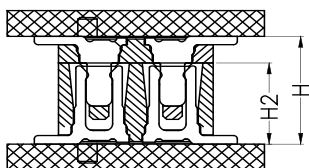

ASS'Y HIGH(H)	PLUG(H1)	SOCKET(H2)
4.00	1.00	3.00
4.50	1.50	3.00
5.00	2.00	3.00
5.50	1.50	4.00
6.00	2.00	4.00
6.50	2.00	4.50
7.00	3.00	4.00
7.50	3.00	4.50
8.00	4.00	4.00

# 3610 Series

## Dimensions 尺寸(Socket 插座)

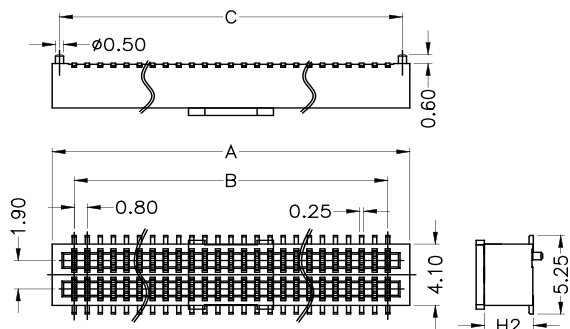

## PCB Layout 印刷电路板布局(SMT)

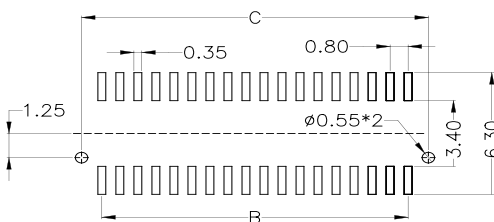

## Order Information 订购信息

Circuit 芯数	Product height 产品高度 (mm)	Part number 型号	Plating 电镀	Dimensions 尺寸 (mm)			Parkage 包装 Q'ty/Reel 只/卷装	Remake 可量产状态
				A	B	C		
10	H2=3.00	3610-S010-030GXR01	GX: G1=3u"Gold G3=10u"Gold G5=30u"Gold	5.90	3.20	5.00	1100	*
	H2=4.00	3610-S010-040GXR01					1000	*
	H2=4.50	3610-S010-045GXR01					900	*
20	H2=3.00	3610-S020-030GXR01	GX: G1=3u"Gold G3=10u"Gold G5=30u"Gold	9.90	7.20	9.00	1100	*
	H2=4.00	3610-S020-040GXR01					1000	*
	H2=4.50	3610-S020-045GXR01					900	*
30	H2=3.00	3610-S030-030GXR01	GX: G1=3u"Gold G3=10u"Gold G5=30u"Gold	13.90	11.20	13.00	1100	*
	H2=4.00	3610-S030-040GXR01					1000	*
	H2=4.50	3610-S030-045GXR01					900	*
40	H2=3.00	3610-S040-030GXR01	GX: G1=3u"Gold G3=10u"Gold G5=30u"Gold	17.90	15.20	17.00	1100	*
	H2=4.00	3610-S040-040GXR01					1000	*
	H2=4.50	3610-S040-045GXR01					900	*
50	H2=3.00	3610-S050-030GXR01	GX: G1=3u"Gold G3=10u"Gold G5=30u"Gold	21.90	19.20	21.00	1100	*
	H2=4.00	3610-S050-040GXR01					1000	*
	H2=4.50	3610-S050-045GXR01					900	*
80	H2=3.00	3610-S080-030GXR01	GX: G1=3u"Gold G3=10u"Gold G5=30u"Gold	33.90	31.20	33.00	1100	*
	H2=4.00	3610-S080-040GXR01					1000	*
	H2=4.50	3610-S080-045GXR01					900	*
100	H2=3.00	3610-S100-030GXR01	GX: G1=3u"Gold G3=10u"Gold G5=30u"Gold	41.90	39.20	41.00	1100	*
	H2=4.00	3610-S100-040GXR01					1000	*
	H2=4.50	3610-S100-045GXR01					900	*

Note: \* stands for mass production . 注: \*代表可量产

Dimensions 尺寸 (Plug 插头)

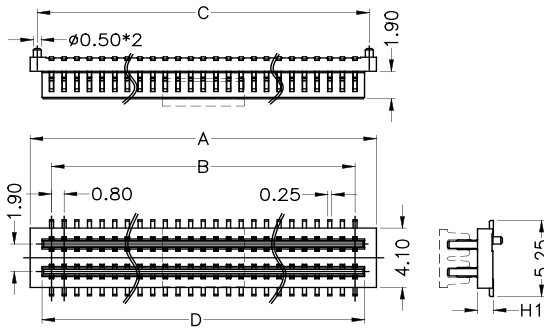

PCB Layout 印刷电路板布局 (SMT)

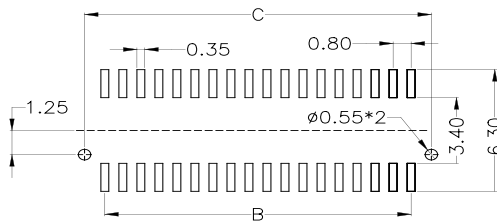

Order Information 订购信息

Circuit 芯数	Product height 产品高度 (mm)	Part number 型号	Plating 电镀	Dimensions 尺寸 (mm)			Package 包装 Q'ty/Reel 只/卷装	Remake 可量产状态
				A	B	C		
10	H2=1.00	3610-P010-010GXR01	GX: G1=3u"Gold G3=10u"Gold G5=30u"Gold	5.90	3.20	5.00	1100	*
	H2=1.50	3610-P010-015GXR01					1000	
	H2=2.00	3610-P010-020GXR01					1000	*
	H2=3.00	3610-P010-030GXR01					850	
	H2=4.00	3610-P010-040GXR01					700	
20	H2=1.00	3610-P020-010GXR01	GX: G1=3u"Gold G3=10u"Gold G5=30u"Gold	9.90	7.20	9.00	1100	*
	H2=1.50	3610-P020-015GXR01					1000	*
	H2=2.00	3610-P020-020GXR01					1000	*
	H2=3.00	3610-P020-030GXR01					850	*
	H2=4.00	3610-P020-040GXR01					700	*
30	H2=1.00	3610-P030-010GXR01	GX: G1=3u"Gold G3=10u"Gold G5=30u"Gold	13.90	11.20	13.00	1100	*
	H2=1.50	3610-P030-015GXR01					1000	
	H2=2.00	3610-P030-020GXR01					1000	*
	H2=3.00	3610-P030-030GXR01					850	
	H2=4.00	3610-P030-040GXR01					700	
40	H2=1.00	3610-P040-010GXR01	GX: G1=3u"Gold G3=10u"Gold G5=30u"Gold	17.90	15.20	17.00	1100	*
	H2=1.50	3610-P040-015GXR01					1000	*
	H2=2.00	3610-P040-020GXR01					1000	*
	H2=3.00	3610-P040-030GXR01					850	
	H2=4.00	3610-P040-040GXR01					700	
50	H2=1.00	3610-P040-010GXR01	GX: G1=3u"Gold G3=10u"Gold G5=30u"Gold	21.90	19.20	21.00	1100	
	H2=1.50	3610-P040-015GXR01					1000	
	H2=2.00	3610-P040-020GXR01					1000	*
	H2=3.00	3610-P040-030GXR01					850	
	H2=4.00	3610-P040-040GXR01					700	*
80	H2=1.00	3610-P080-010GXR01	GX: G1=3u"Gold G3=10u"Gold G5=30u"Gold	33.90	31.20	33.00	1100	*
	H2=1.50	3610-P080-015GXR01					1000	
	H2=2.00	3610-P080-020GXR01					1000	*
	H2=3.00	3610-P080-030GXR01					850	
	H2=4.00	3610-P080-040GXR01					700	
100	H2=1.00	3610-P100-010GXR01	GX: G1=3u"Gold G3=10u"Gold G5=30u"Gold	41.90	39.20	41.00	1100	
	H2=1.50	3610-P100-015GXR01					1000	
	H2=2.00	3610-P100-020GXR01					1000	*
	H2=3.00	3610-P100-030GXR01					850	
	H2=4.00	3610-P100-040GXR01					700	

Note: \* stands for mass production . 注: \*代表可量产

## 3610 Series

### Model Numbering 型号命名

<b>3610</b>	-	<b>S</b>	<b>XXX</b>	-	<b>XXX</b>	<b>XX</b>	<b>R</b>	<b>01</b>
(1)		(2)	(3)		(4)	(5)	(6)	(7)
(1) Series (系列): 0.80mm BTB Series						(5) Plating(电镀): G1=3u"Gold、G3=10u"Gold、G5=30u"Gold		
(2) Product type (产品类型): S=Socket 插座						(6) Packing(包装): R=Reel&Reel		
(3) Positions (位数): 010=10P.....100=100P						(7) Running Number (流水码)		
(4) Housing High(塑胶高度): 030=3.00mm 040=4.00mm、045=4.50mm								

<b>3610</b>	-	<b>P</b>	<b>XXX</b>	-	<b>XXX</b>	<b>XX</b>	<b>R</b>	<b>01</b>
(1)		(2)	(3)		(4)	(5)	(6)	(7)
(1) Series (系列): 0.80mm BTB Series						(5) Plating(电镀): G1=3u"Gold、G3=10u"Gold、G5=30u"Gold		
(2) Product type (产品类型): P=Pulg 插头						(6) Packing(包装): R=Reel&Reel		
(3) Positions (位数): 010=10P.....100=100P						(7) Running Number (流水码)		
(4) Housing High(塑胶高度): 010=1.00mm 015=1.50mm、020=2.00mm、030=3.00mm、040=4.00mm								

## Contact Us 联系我们

维峰电子股份有限公司(总部)  
WCON ELECTRONICS CO.,LTD(HQ)  
地址:广东省东莞市虎门镇大宁文明路15号  
Add :No.15,Wenming Road,Daning Community, Humen Town, Dongguan, Guangdong.523930, China

昆山维康电子有限公司  
KUNSHAN WCON ELECTRONICS CO.,LTD(East of China)  
地址:昆山市千灯镇汶浦中路169号  
Add : No.169, WenPu Middle Road, QianDeng Town, Kunshan City, Jiangsu Province, China

合肥维峰电子有限公司  
HEFEI WCON ELECTRONICS CO.,LTD  
地址:安徽合肥市高新技术开发区绿城科技园E栋2楼  
Add : 2F, Building E, Greentown Science Park,High-tech Development Zone, Hefei, Anhui,China

维康电子(泰国)有限公司  
WCON ELECTRONICS (Thailand) CO.,LTD  
地址:泰国巴真武里府西玛铺县华瓦区洛加纳工业园  
Add: VG3C+H57, Hua Wa, Si Maha Phot District, Prachin Buri 25140, Thailand

### 销售联系方式 Contacts Information

国际客户部 International sales department  
salesdg01@wcon.com  
salesdg05@wcon.com

大客户专线 Major customer dedicated department  
华南: salesdg28@wcon.com  
华东: salesks@wcon.com

中小客户专线 Public Customer hot line  
华南: salesdg10@wcon.com  
华东: salesks01@wcon.com

网络销售 Online sales department  
salesdg26@wcon.com



Official Website



Product e-catalog



WeChat Public#



TikTok Public#