

HSF

Recommended P.C.B Layout (Top Side)
(PCB BOARD TOLERANCE ±0.05)

NOTES:

Current Rating: 2.0AMP
 Contact Resistance: 20mΩ Max
 Withstand Voltage: 500V AC/DC
 Insulation Resistance: 1000MΩ Min
 Operation Temperature: -40℃ to +105℃

Housing Material: PA9T+33%GF Black(UL94V-0)
 Contact Material: Brass
 Contact plating: Au or Sn over Ni

Ordering Information

3122A-XX M XX B K00 X 1

No.of Pins	Contact Plating	Color Insulator	Packing
8-50P	G0=Gold Flash G3=10u"Gold G4=15u"Gold G5=30u"Gold S0=Gold Flash/Tin S3=10u"Gold/Tin S4=15u"Gold/Tin S5=30u"Gold/Tin SN=Tin	B=Black	T=Tube P=Tube+CAP R=Tape&Reel+CAP

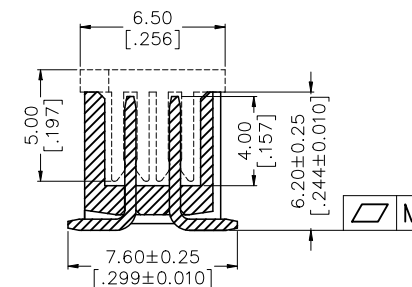
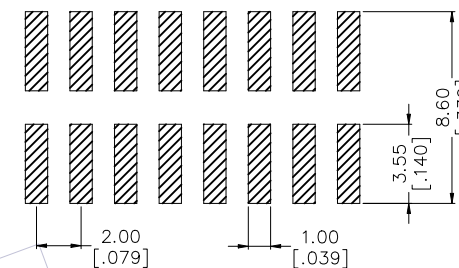
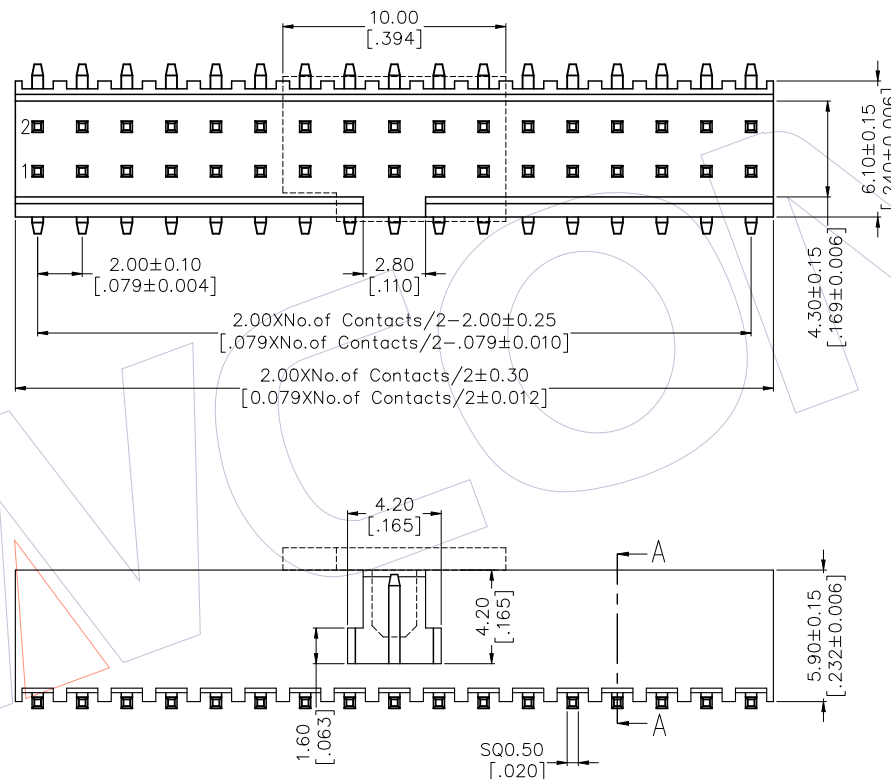

SECTION A-A



PIN(PerRow)	8-20P	22-40P	42-50P
M	0.10	0.12	0.15

REV	DATE	MODIFICATION DESCRIPTION	CHANGE	OPERATION	DRAW	DATE	SCALE	PART NO.
A1	2023.02.16	Add Flatness	DuYing	X.X ±0.40	DuYing	2023.02.16	1:1	3122A-XXMXXBK00X1
A0	2019.08.23	NEW	Liu	X.XX ±0.25	CHECK	DATE	UNIT mm	TITLE: 2.00 BOX HEADER SMT H=5.90 "F" TYPE
				X.XXX ±0.15	APPROVE	DATE	SIZE A4	Customer NO.
				Angle ± 3°			SHEET 1/1	
				DIM TOL			PROJ.	

WCON
 Http: www.wcon.com

WCON-Dongguan Tel: +86 769 85358920 Fax: +86 769 85358915 E-mail: sales@wcon.com	WCON-Kunshan Tel: +86 512 57468408 Fax: +86 512 57468468 E-mail: sales@wcon.com
---	--