

HSF

NOTES:
 Current Rating: 1.0AMP
 Contact Resistance: 10mΩ Max
 Withstand Voltage: 1000V AC/DC
 Mechanical Life: Min 100 cycles
 Connecting Pin: Ø0.50mm
 Operation Temperature: -40°C to +105°C

Contact Material: Brass CuZn36Pb3(C36000)
 Contact plating: Au over Ni
 Insulator Material: PPS+30%G.F UL94V-0

Recommended P.C.B Layout(Top Side)
 (PCB BOARD TOLERANCE ±0.05)

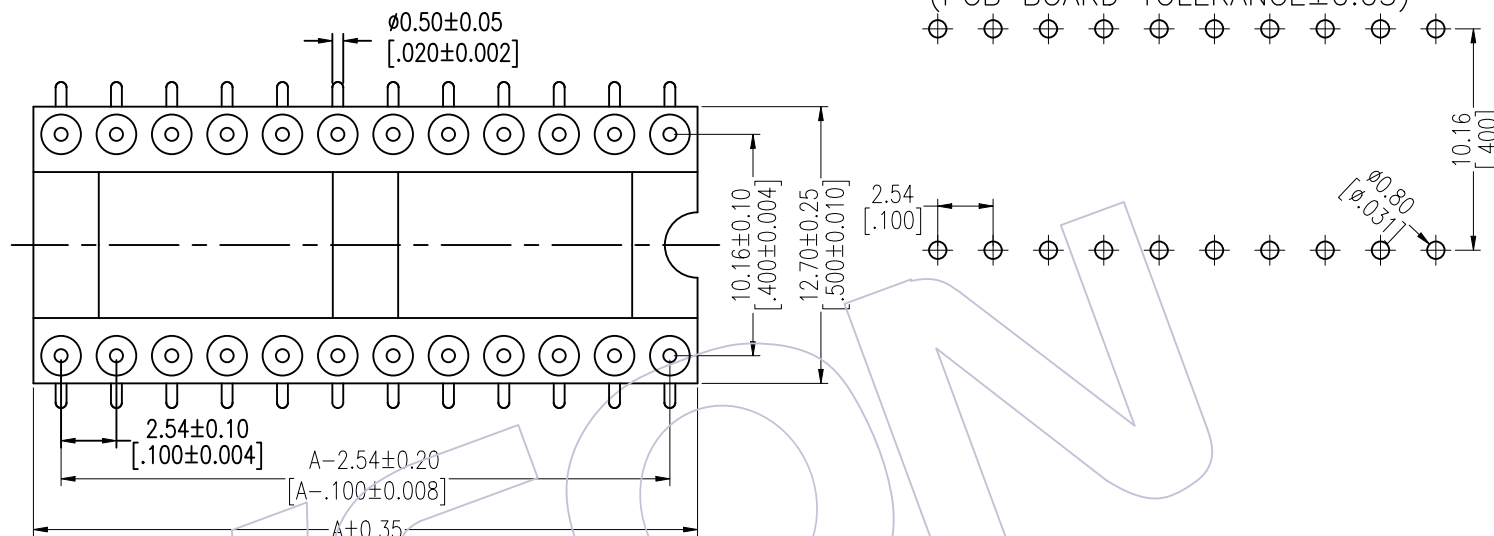

Ordering Information

3560-303 XX M XX 102 X 1

Row of Pitch: 3=10.16mm
 No. of Pin: See tab
 Contact Plating:
 G0=Gold Flash
 G3=10u"Gold
 G4=15u"Gold
 G5=30u"Gold
 Packing:
 T=Tube
 R=Tape&Reel

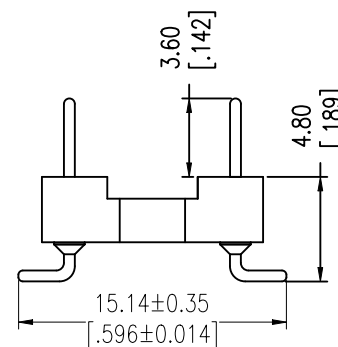
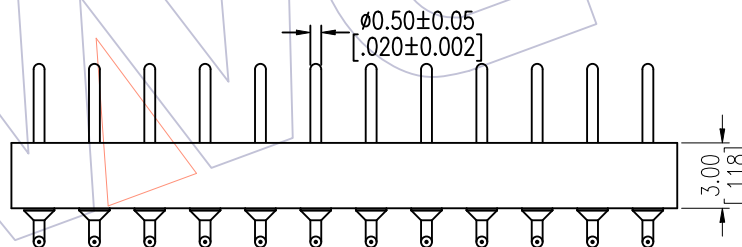

Dimensional & Ordering Information

NO. of Poles	Part No.	Dim
		A
20	3560-30320MXX102X1	25.40
22	3560-30322MXX102X1	27.94
24	3560-30324MXX102X1	30.48
28	3560-30328MXX102X1	35.56
32	3560-30332MXX102X1	40.64

REV	DATE	MODIFICATION DESCRIPTION	CHANGE	OPERATION	DRAW	DATE	SCALE	FIT	PART NO.
A0	2012/11/05	NEW	-----	X.X ±0.40	JYHuang	2012/11/05	UNIT mm		SEE TAB
				X.XX ±0.25	CHECK	DATE	SIZE A4		TITLE:
				X.XXX ±0.15	APPROVE	DATE	SHEET 1/1		2.54mm MACHINED ADAPTER CONNECTOR
				Angle ± 3'			PROJ.		SMT H=3.0 L=10.20 Row of Pitch 10.16
				DIM TOL					Customer NO.

WCON

Http: www.wcon.com

WCON-Dongguan
 Tel: +86 769 85358920
 Fax: +86 769 85358915
 E-mail: sales@wcon.com

WCON-Kunshan
 Tel: +86 512 57468408
 Fax: +86 512 57468468
 E-mail: salesks@wcon.com