

HSF

Ordering Information

6342 - XX F H 00 J B W 01

Pin
16=16Pin
24=24Pin
32=32Pin
40=40Pin

Wcon Internal Code

W/ SCREW&NUT

BLACK

FEMALE
BONDING WIRE
WO/CONN
SLANTING

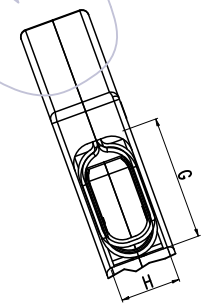
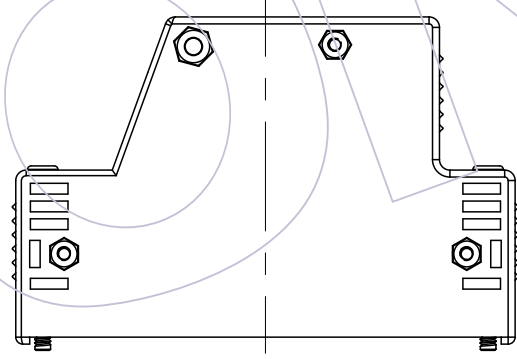
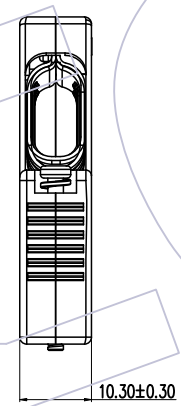
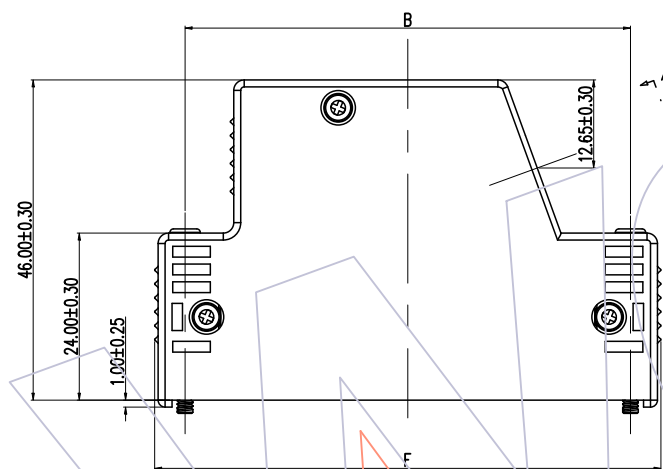
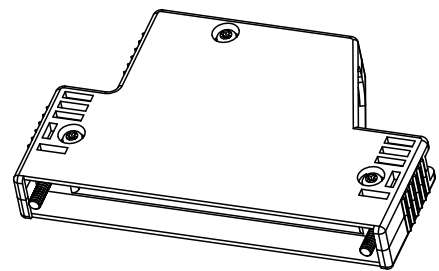
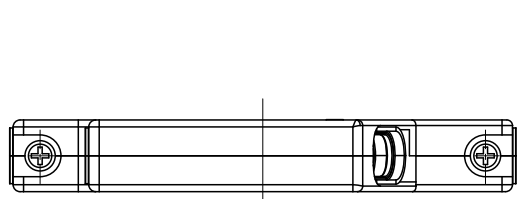

View A-A
Scale 1:1

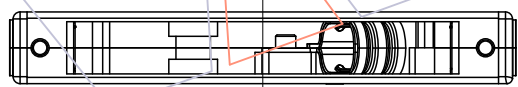

BOM

ITEM	descriptionn	Part Number	quantity	materials
(8)	CABLE CLAMP	B6341-AN102 B6341-AN101	1	SUS,NICKEL PLATING
(7)	LOCK-SCREW ASSEMBLY	L6341-SM004	2	SUS,
(6)	LOCK-CABLE SCREW	L6220-SXX02	1(32-64) 2(16,24P)	SUS,NICKEL PLATING
(5)	LOCK-CABLE NUT	N6220-SXX01	1(32-64) 2(16,24P)	STEEL,NICKEL PLATING
(4)	SCREW	L3210P-SNI01	3	SUS,M2.0*9.30mm,Plating Ni
(3)	NUT	N3210P-SNI01	3	Steel,M2.0*1.6T,Plating Ni
(2)	PLASTIC BOTTOM COVER	G6341-BXXFBSM003	1	ABS+PC UL94-V0
(1)	PLASTIC TOP COVER	G6341-AXXFBSM003	1	ABS+PC UL94-V0

REV	DATE	MODIFICATION DESCRIPTION	CHANGE	OPERATION	DRAW	DATE	SCALE	FIT	PART NO.
AO	2021/08/30	NEW	Morris	X.X ±0.40	Morris	2021/08/30	UNIT mm		6342 - XX F H 00 J B W 01
				X.XX ±0.25	CHECK	DATE	SIZE A4		TITLE:
				X.XXX ±0.15	APPROVE	DATE	SHEET 1/3		2.54*2.54mm DFCN 双排 斜出线 塑胶壳组件, 6件套
				Angle ± 3°			PROJ.		Customer NO.
				DIM TOL					



WCON-Dongguan
Tel: +86 769 85358920
Fax: +86 769 85358915
E-mail: sales@wcon.com

WCON-Kunshan
Tel: +86 512 57468408
Fax: +86 512 57468468
E-mail: sales@wcon.com

HSF

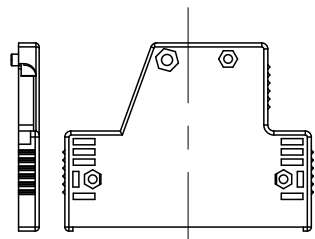

32P BOTTOM COVER

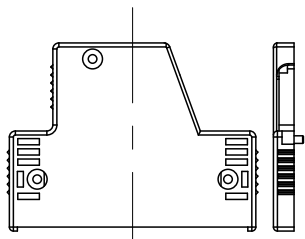

32P TOP COVER

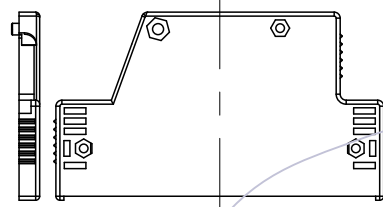

48P BOTTOM COVER

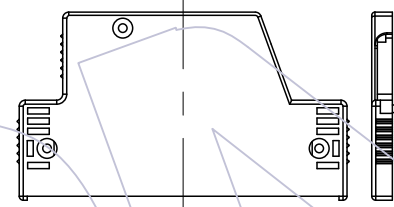

48P TOP COVER

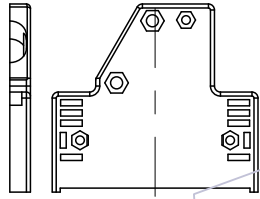

24P BOTTOM COVER

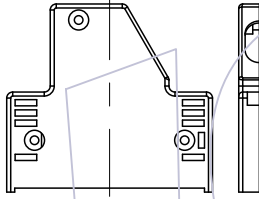

24P TOP COVER

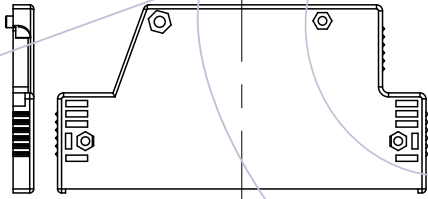

56P BOTTOM COVER

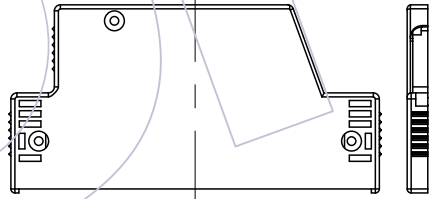

56P TOP COVER

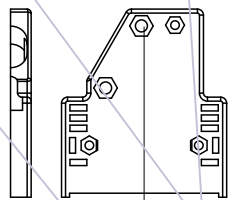

16P BOTTOM COVER

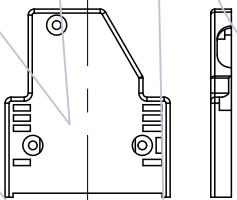

16P TOP COVER

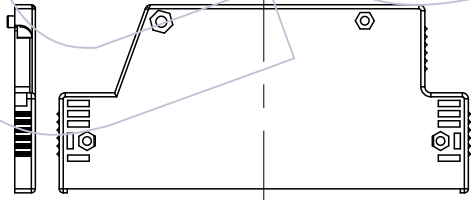

64P BOTTOM COVER

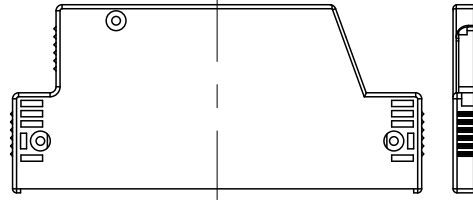

64P TOP COVER



锁线六角螺母



锁线螺钉



六角螺母



固定螺钉组件



锁紧螺钉组件

AO	2021/08/30	NEW	Morris
REV	DATE	MODIFICATION DESCRIPTION	CHANGE

OPERATION	
X.X	±0.40
X.XX	±0.25
X.XXX	±0.15
Angle	± 3°
DIM	TOL

DRAW	Morris
CHECK	
APPROVE	

DATE	2021/08/30
DATE	
DATE	

SCALE	FIT
UNIT	mm
SIZE	A4
SHEET	2/3
PROJ.	⌀ ↗

PART NO.	6342 - XX F H 00 J B W 01
TITLE:	2.54*2.54mm DFCN 双排 斜出线 塑胶壳组件, 6件套
Customer NO.	

WCON
Http: www.wcon.com

WCON-Dongguan Tel: +86 769 85358920 Fax: +86 769 85358915 E-mail: sales@wcon.com	WCON-Kunshan Tel: +86 512 57468408 Fax: +86 512 57468468 E-mail: sales@wcon.com
---	--

HSF

配合连接器: P/N: 6340-1XXFSSXM1NT01

配合连接器: P/N: 6340-1XXFSSXM1NT01

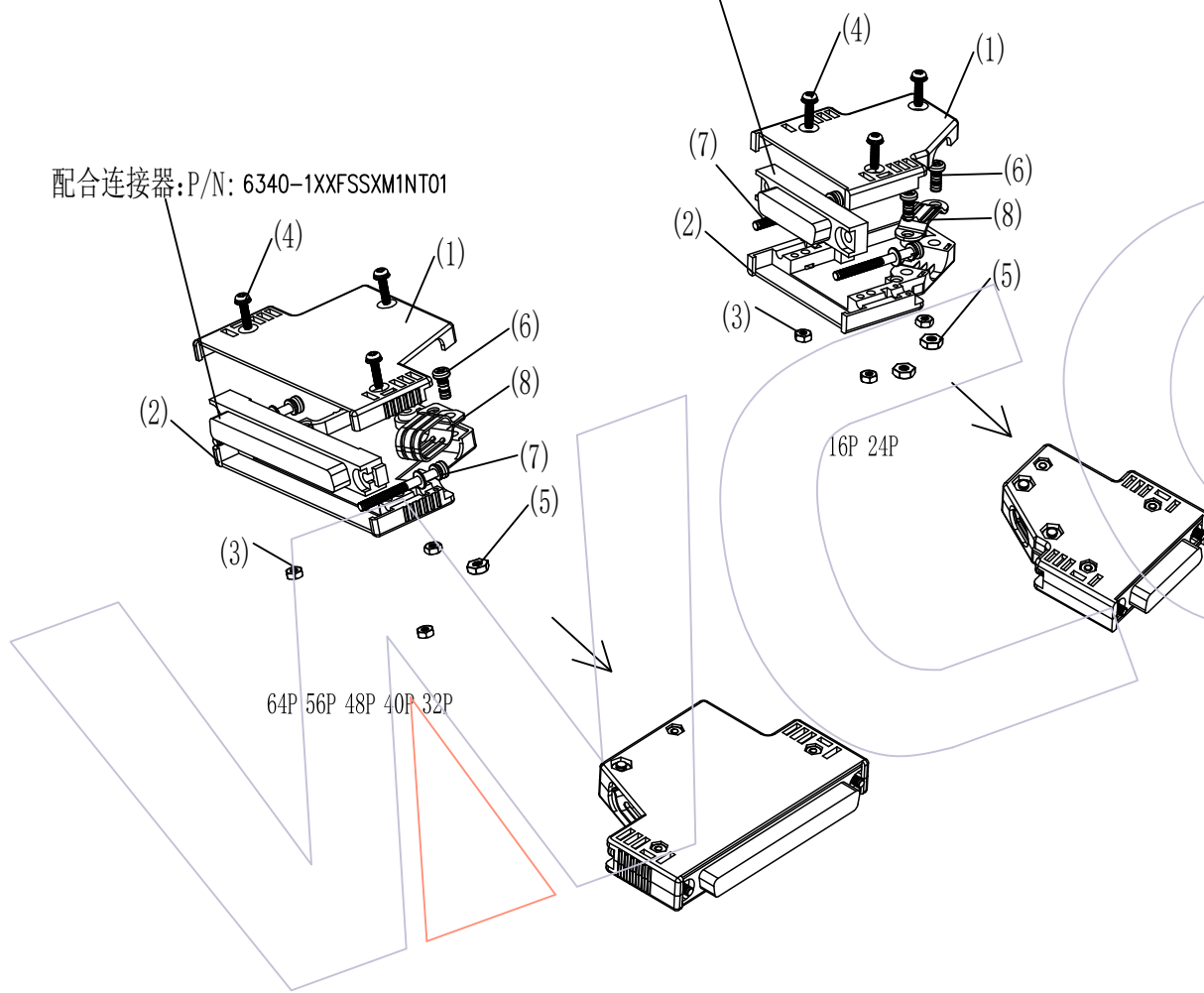

装配及应用:

1. 如图, 将HOUSING组件如图示装入上下壳中, 装入螺定与六角螺母固定;

2. Applicable Wires and Contact Sizes

Size #1	AWG 24 (For UL1061)	Insulation outside diameter: 1.1 to 1.3mm
Size #1	AWG 28 or AWG26 (For UL1007)	

16P	33.50 ±0.30	42.24 ±0.30	12.00 ±0.30	7.60 ±0.30
24P	43.66 ±0.30	52.40 ±0.30	12.00 ±0.30	7.60 ±0.30
32P	53.82 ±0.30	62.56 ±0.30	17.90 ±0.35	8.70 ±0.35
40P	63.98 ±0.30	72.72 ±0.30		
48P	74.14 ±0.30	82.88 ±0.30		
56P	84.30 ±0.35	93.04 ±0.35		
64P	94.46 ±0.35	103.20 ±0.40		
位数	B	F	G	H

				OPERATION	DRAW	DATE	SCALE	FIT	PART NO.	 Http: www.wcon.com WCON-Dongguan Tel: +86 769 85358920 WCON-Kunshan Tel: +86 512 57468408 Fax: +86 769 85358915 Fax: +86 512 57468468 E-mail: sales@wcon.com E-mail: sales@wcon.com
				X.X ±0.40	Morris	2021/08/30	UNIT	mm	6342-XXFH00JBW01	
				X.XX ±0.25	CHECK	DATE	SIZE	A4	TITLE:	
				X.XXX ±0.15	APPROVE	DATE	SHEET	3/3	2.54*2.54mm DFCN 双排 斜出线 塑胶壳组件, 6件套	
AO	2021/08/30	NEW	Morris	Angle ± 3°			PROJ.	⌀	Customer NO.	
REV	DATE	MODIFICATION DESCRIPTION	CHANGE	DIM TOL						