

HSF

Recommended P.C.B Layout(Top Side)
(PCB BOARD TOLERANCE±0.05)

NOTES:

Current Rating: 3.0AMP
Contact Resistance:30mΩ max
Withstand Voltage:1000V AC/DC
Insulation Resistance:1000MΩ
Operation Temperature: -55℃~+105℃

Contact Material: Brass
Contact Plating: Au and Sn over Ni
Fixing Material: Phosphor Bronze
Fixing Plating: Sn over Ni
Insulation Material: PBT+30% G.F(UL94V-0)

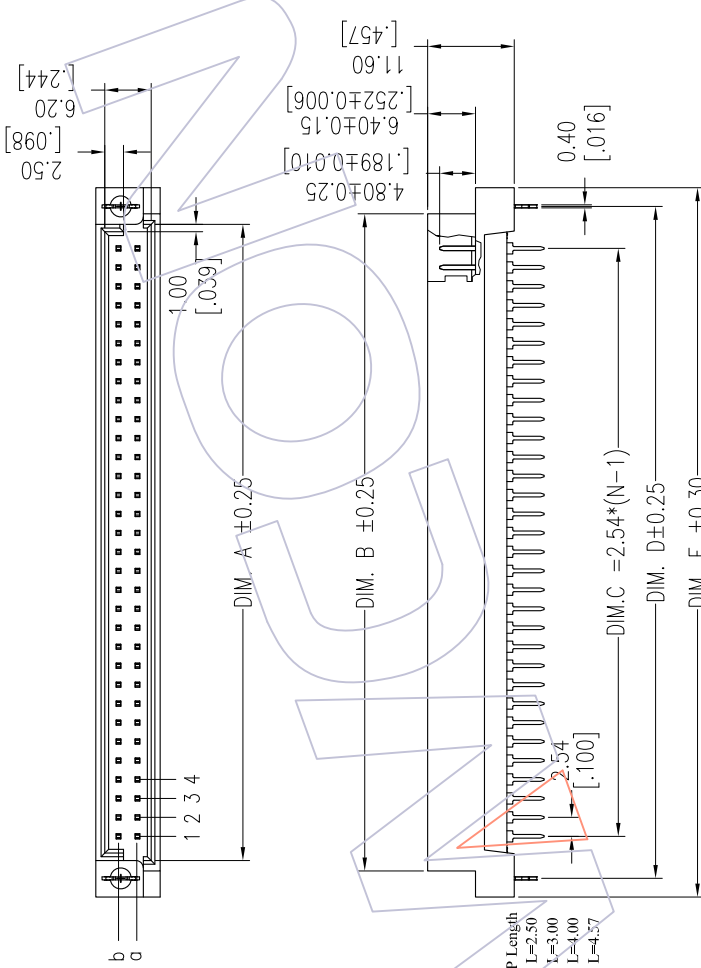
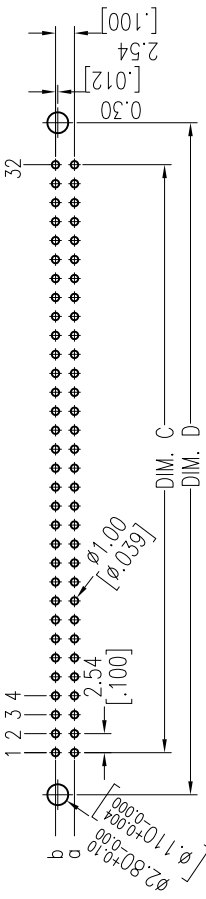

No. of Pins Per Row: 10pin, 16pin, 32pin
Rows with Contacts: B=q+b, D=a
Contact Plating: S0=Gold Flash/Tin, S1=3u"Gold/Tin, S3=10u"Gold/Tin, S4=15u"Gold/Tin, S5=30u"Gold/Tin, SN=Tin
Packing DIP Length: 1: L=2.50, 2: L=3.00, 3: L=4.00, 4: L=4.57
A=Tray
W=With Lock, N=Without Lock

Ordering Information

3410-2 XX X MS SX X A X

W: With Lock
N: Without Lock

Q	64	2	32	85.20	88.00	78.74	90.00	95.00
Q/2	32	2	16	44.60	47.40	38.10	50.00	55.00
Q/3	20	2	10	29.30	32.10	22.86	34.76	39.76
TYPE	PDS.	ROWS	N	DIM.A	DIM.B	DIM.C	DIM.D	DIME

REV	DATE	MODIFICATION DESCRIPTION	CHANGE	OPERATION	DRAW	DATE	SCALE	FIT	PART NO.	Customer NO.
A1	2014/08/12	Modify the dim	—	X.X ±0.40	JYHuang	2014/08/12	UNIT	FORM	3410-2XXXXSSXXAX	WCON-Dongguan Http: www.wcon.com
A0	2014/05/29	NEW	—	X.XX ±0.25	CHECK	DATE	SIZE	A4	2.54PITCH DIN 41612	WCON-Kunshan Tel: +86 769 85358920 Tel: +86 512 57468408
				X.XXX ±0.15	APPROVE	DATE	SHEET	1/1	Male 180° DIP (Q-Type)	Fax: +86 769 85358915 Fax: +86 512 57468468
				Angle ± 3°			PROJ.			E-mail: sales@wcon.com E-mail: sales@wcon.com
				DIM TOL						

WCON
Http: www.wcon.com