

NOTES:  
 Current Rating: 0.5A  
 Voltage Rating: 50V AC/DC  
 Contact Resistance: 50milliohm Max  
 Insulation Resistance: 100Megohm Min  
 Operation Temperature: -40℃to+105℃

Housing Material: PA9T+33%G.F(UL94V-0)  
 Contact Material: Phosphor Bronze  
 Contact plating: Au or Sn over Ni

Recommended P.C.B Layout (Top Side)  
 (PCB BOARD TOLERANCE ±0.05)

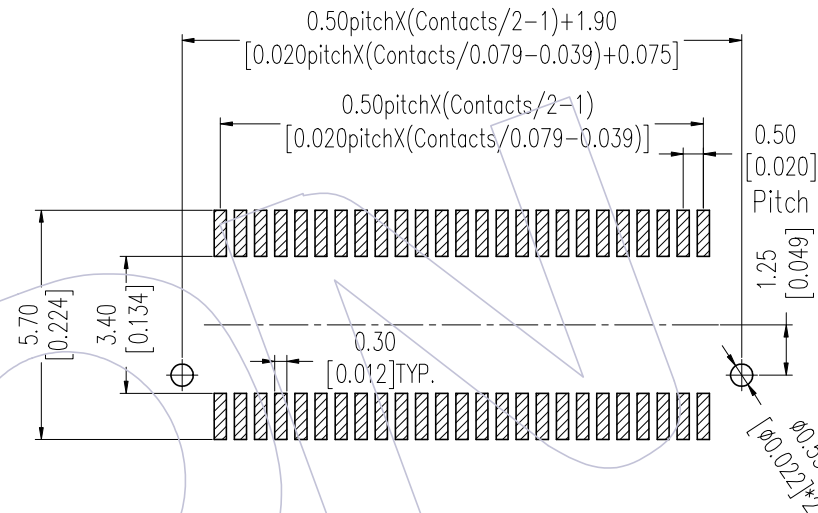
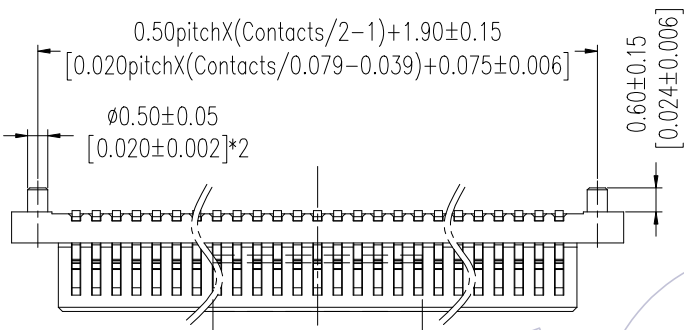

Ordering Information

3620-P XXX - XXX XX R OX

|             |              |                 |                 |             |
|-------------|--------------|-----------------|-----------------|-------------|
| No. of Pins | Housing High | Contact Plating | T=Tube          | 01=W/T Post |
| 10-100Pin   | 008-0.80     | G1=3u"Gold      | P=Tube+CAP      | 02=W/O Post |
| Std Pin     | 010-1.00     | G2=5u"Gold      | R=Tape&Reel+CAP |             |
| 10P 60P     | 015-1.50     |                 |                 |             |
| 20P 70P     | 020-2.00     |                 |                 |             |
| 30P 80P     |              |                 |                 |             |
| 40P 90P     |              |                 |                 |             |
| 50P 100P    |              |                 |                 |             |

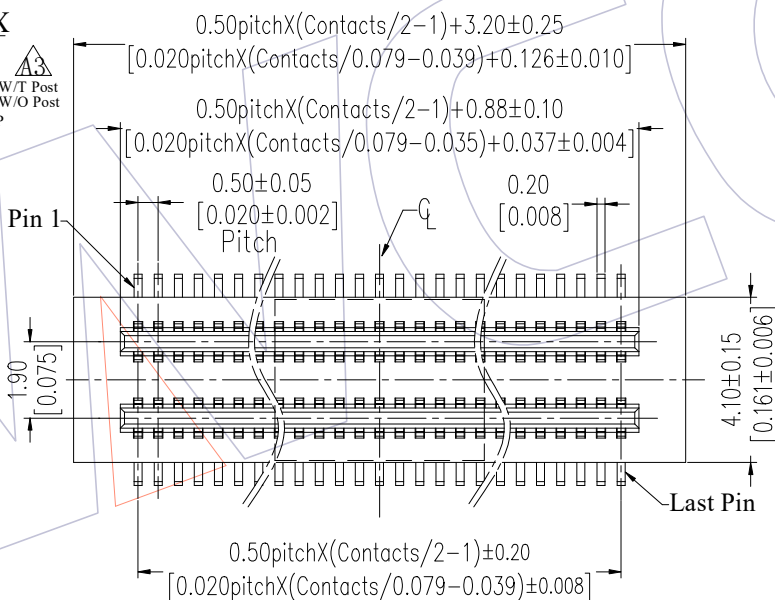

| ASS'Y HIGH(H) | PLUG(H1) | SOCKET(H2) | SOCKET(N) |
|---------------|----------|------------|-----------|
| 3.00          | 0.80     | 2.20       | 1.70      |
| 3.50          | 0.80     | 2.70       |           |
| 4.00          | 1.00     | 3.00       |           |
| 4.50          | 1.50     | 3.00       |           |
| 5.00          | 2.00     | 3.00       | 1.90      |
| 5.50          | 1.50     | 4.00       |           |
| 6.00          | 2.00     | 4.00       |           |
| 6.50          | 2.00     | 4.50       |           |

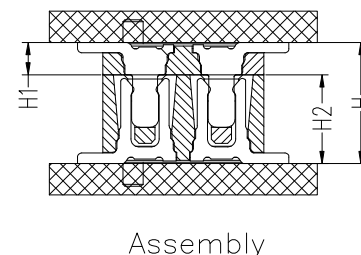
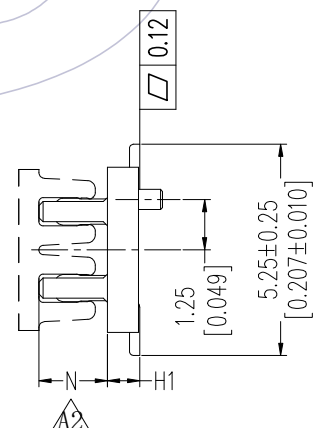

| REV | DATE       | MODIFICATION DESCRIPTION | CHANGE | OPERATION   | DRAW    | DATE       | SCALE | FIT  | PART NO.                            |
|-----|------------|--------------------------|--------|-------------|---------|------------|-------|------|-------------------------------------|
| A3  | 2019/07/09 | Modify                   | A3     | OPERATION   | Ding    | 2018/06/28 | SCALE | mm   | 3620-PXXX-XXXXXROX                  |
| A2  | 2018/06/28 | Modify                   | A2     | x.x ±0.40   | CHECK   | DATE       | UNIT  | inch | TITLE:                              |
| A1  | 2017/06/26 | Modify                   | A1     | x.xx ±0.25  | APPROVE | DATE       | SIZE  | A4   | 0.50mm B TO B<br>MALE 180° SMT TYPE |
| A0  | 2012/06/27 | NEW                      |        | x.xxx ±0.15 |         |            | SHEET | 1/1  | Customer NO.                        |
|     |            |                          |        | Angle ± 3°  |         |            | PROJ. |      |                                     |
|     |            |                          |        | DIM TOL     |         |            |       |      |                                     |

**WCON**  
 Http: www.wcon.com

WCON-Dongguan Tel: +86 769 85358920  
 WCON-Kunshan Tel: +86 512 57468408  
 Fax: +86 769 85358915  
 Fax: +86 512 57468468  
 E-mail: sales@wcon.com  
 E-mail: salesks@wcon.com