

# HSF

**NOTES:**

Current Rating: 2.0AMP  
 Contact Resistance: 20mΩ Max  
 Withstand Voltage: 500V AC/DC  
 Insulation Resistance: 1000MΩ Min  
 Operation Temperature: -40°C to +105°C

Contact Material: Phosphor Bronze  
 Contact plating: Au Or Sn over Ni  
 Insulator Material: LCP+30%G.F UL94V-0



Recommended P.C.B Layout (Top Side)  
 (PCB BOARD TOLERANCE ±0.05)

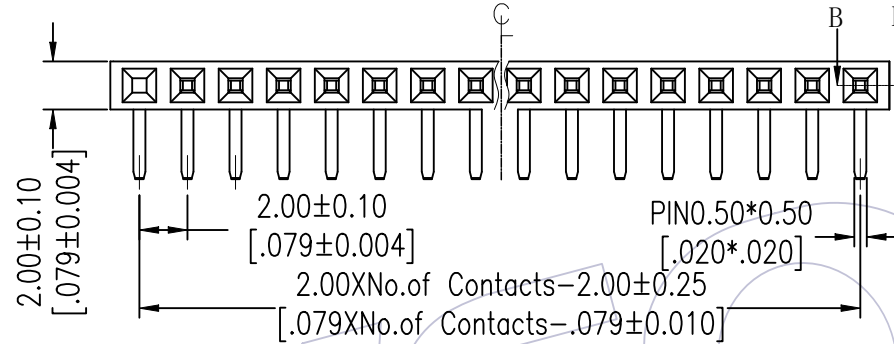
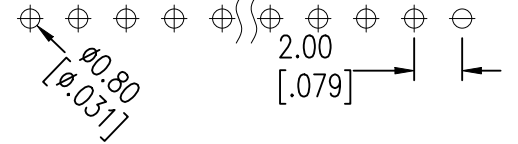

## Ordering Information

2263 - 1 XX R XX D Y N T 1

No. of Pins per ROW: 02-40PIN  
 Contact Plating:  
 G0=Gold Flash  
 G3=10μ"Gold  
 G4=15μ"Gold  
 G5=30μ"Gold  
 S0=Gold Flash/Tin  
 S3=10μ"Gold/Tin  
 S4=15μ"Gold/Tin  
 S5=30μ"Gold/Tin  
 SN=Tin  
 SM=Matte Tin  
 Insulator:  
 D=LCP  
 Packing:  
 T=Tube

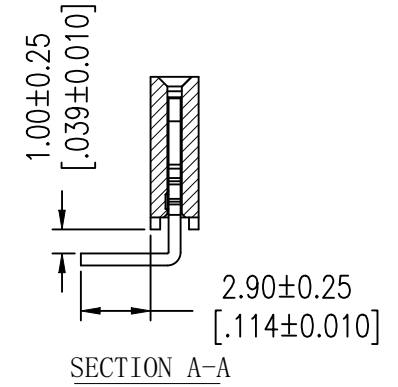
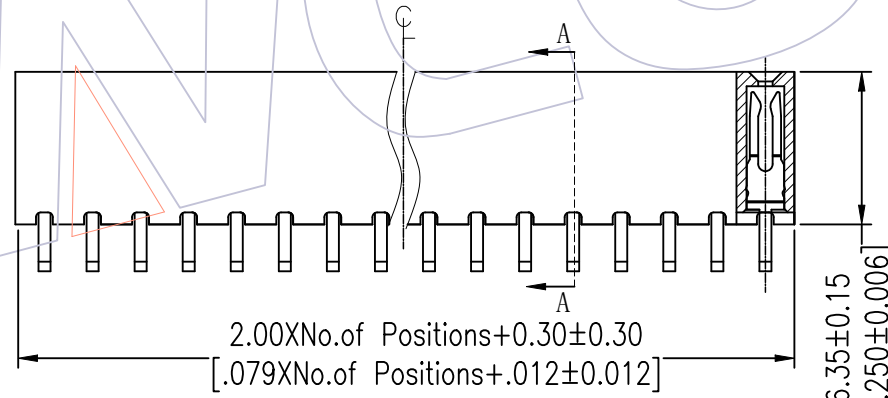

Item	Pitch	Mating
Standard	2.00	1215/1220
Alternate		

REV	DATE	MODIFICATION DESCRIPTION	CHANGE	OPERATION		DRAW Wang	DATE 2013/03/15	SCALE UNIT mm	FIT A4	PART NO. 2263-1XXRXXDYNT1
				Angle	± 3'					
A1	2013/03/15	Modify drawing	-----	x.xx	±0.40	CHECK	DATE	SIZE	1/1	TITLE: FH2.0mm SINGLE ROW 90° SMT H=6.35
A0	2012/12/7	NEW	-----	x.xxx	±0.15	APPROVE	DATE	SHEET	1/1	Customer NO.
				DIM	TOL			PROJ.		

# WCON

Http: www.wcon.com  
 WCON-Dongguan Tel: +86 769 85358920 Fax: +86 769 85358915 E-mail: sales@wcon.com  
 WCON-Kunshan Tel: +86 512 57468408 Fax: +86 512 57468468 E-mail: salesks@wcon.com