

# HSF

NOTES:  
 Rated Current: 2.0AMP.  
 Contact Resistance: 20mΩ Max.  
 Withstand Voltage: 500V AC/DC  
 Insulation Resistance: 1000MΩ Min.  
 Operation Temperature: -40°C to +125°C(GOLD)  
 -40°C to +105°C(TIN)  $\Delta 2$

Contact Material: Brass  
 Contact Plating: Au or Sn Over Ni  
 Insulator Material: PA9T+33%G.F UL94V-0 BK

Recommended P.C.B Layout (Top Side)  
 (PCB BOARD TOLERANCE  $\pm 0.05$ )

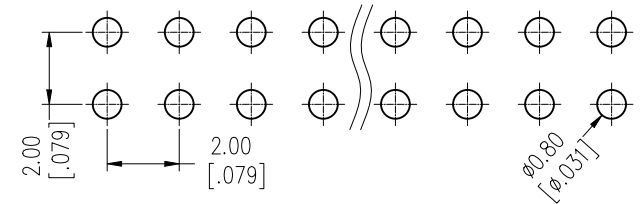
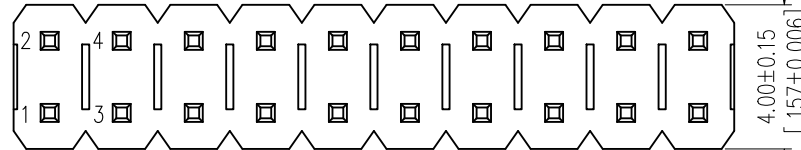

## Ordering Information

1215-12 XX G0 S XXX C 0 XX  $\Delta 1$



No. of Pins	Contact Plating	Pin Length	Insulator Material	Packing	Series No.
Per Row: 02-40	G0=Gold Flash	L=A+B+1.5	C=PA9T	0=PE Bag	01-99
	G3=10u"Gold	Standard: 063=6.3		T=Tube	
	G4=15u"Gold	073=7.3			
	G5=30u"Gold	083=8.3			
	S0=Gold Flash/Tin				
	S3=10u"Gold/Tin				
	S4=15u"Gold/Tin				
	S5=30u"Gold/Tin				
	SN=Tin Plated				
	SM=Matte Tin				

Item	Pin Length	A	B	Mating
Standard	6.30	2.80	2.00	2220T 2221 2227T 2228
	7.30	2.80	3.00	2235
	8.30	2.80	4.00	2240 2243 2263 2272
	6.50	2.50	2.50	
	7.80	2.80	3.50	
	8.00	2.50	4.00	
	8.20	2.70	4.00	
	8.50	3.00	4.00	
	10.00	2.40	6.10	

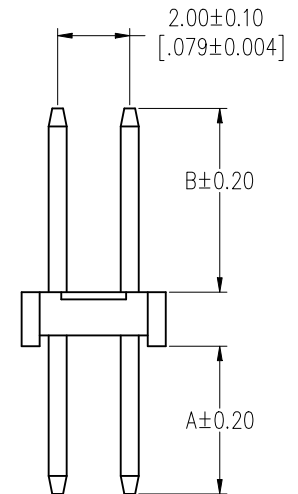
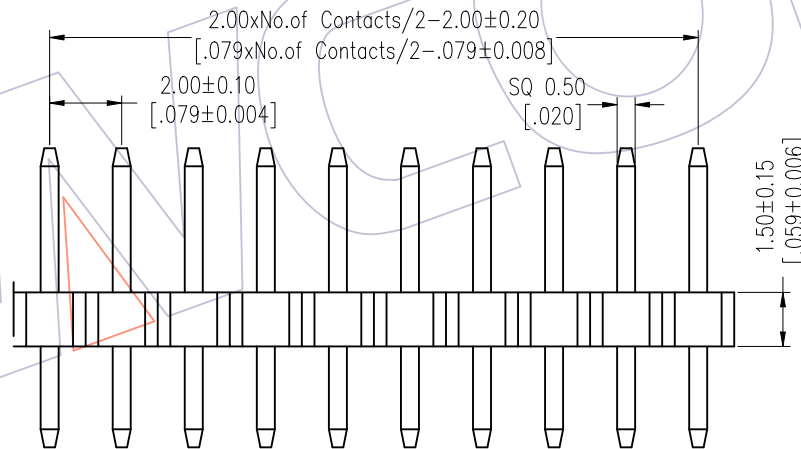

A3	2020/06/11	Modify Pin 02~40P	$\Delta 3$	Da Ying	OPERATION	DRAW	DATE	SCALE	Fit	PART NO. 1215-12XXXXXXXCOXX $\Delta 1$
A2	2019/02/28	Modify	$\Delta 2$	Ding	x.X ± 0.40	Da Ying	2020/06/11	UNIT	mm	
A1	2018/01/18	Modify P/N	$\Delta 1$	-----	x.XX ± 0.25	CHECK	DATE	SIZE	A4	PH2.00 DUAL ROW 180° H=1.5
A0	2012/04/18	NEW	-----	-----	x.XXX ± 0.15	APPROVE	DATE	SHEET	1/1	Customer NO.
REV	DATE	MODIFICATION DESCRIPTION	CHANGE		Angle ± 3°	DIM	TOL	PROJ.		

# WCON

Http: www.wcon.com

WCON-Dongguan	WCON-Kunshan
Tel: +86 769 85358920	Tel: +86 512 57468408
Fax: +86 769 85358915	Fax: +86 512 57468468
E-mail: sales@wcon.com	E-mail: salesks@wcon.com